

149.30'±(D) N59°08'36"E

PROPOSED BOOM (PILING)

TOP OF BANK

EXISTING BIKE PATH
5.5 TO 6' WIDE

969.49'

FLOOD ZONE B

FLOOD ZONE A-6 (6)

PROPOSED
FIT-COURSE
TRAIL

WEST R/W INTRACOASTAL WATERWAY

15' WIDE F/W
ALONG R

S.20°49'48"E

534.78'

20' IRRIGATION PIPELINE CASEMENT

N.20°49'48"W

30.52'

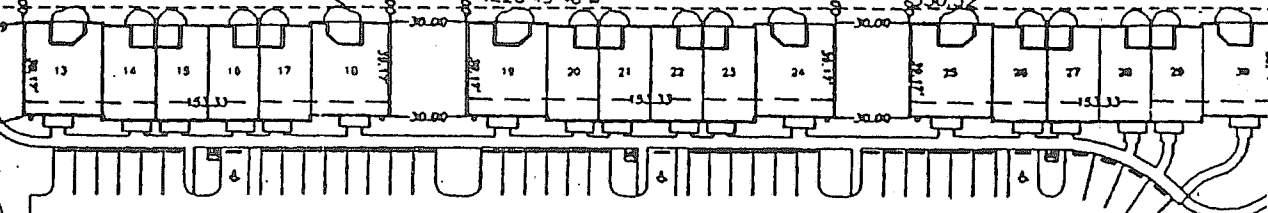

FLOOD ZONE B

PARKING

MIN 10' BUREAU

17.58' R/W

FLOOD ZONE B

POOL

CURVE-G
Δ=038°53'45"
R=768.15'
L=521.46'
CB=N38°40'44"W
Ch=511.51'

CURVE-B
Δ=023°28'46"
R=1045.92'
L=428.61'
CB=N46°27'46"E
Ch=425.62'

1. ALL LAND & PORTIONS OF CONDOMINIUM PROPERTY NOT WITHIN ANY UNIT ARE PART OF THE COMMON ELEMENTS.
2. ALL BEARING WALLS TO THE UNFINISHED SURFACE OF SAID WALLS LOCATED WITHIN A UNIT CONSTITUTE PART OF THE COMMON ELEMENTS.
3. ALL CONDUIT & WIRES TO OUTLETS, & ALL OTHER UTILITY LINES TO OUTLETS, & ALL WASTE PIPES, REGARDLESS OF LOCATION, CONSTITUTE PART OF THE COMMON ELEMENTS.
4. COMMON ELEMENTS ARE SUBJECT TO CERTAIN EASEMENTS SET FORTH IN THE DECLARATION, INCLUDING INGRESS & EGRESS TO PUBLIC BAYS.

DESCRIB
A PARCEL
EAST, FLA

A POINT C
38 A DIST
(200' R/W
SOUTHEAST
OF 167.66
DESCRIPTIVE
THEM
ANGLE OF
WEST RICH
LESS TO A
FOLLOWING
128.17 FEET
NORTHWEST
RADIUS OF
NLS8°07'38'

DATE: 06/27/00

FILE NAME: onth/lwn rmg/11-31/538 PAR 180 99-6120

PARCEL C0